

PASO 50,8
RODILLO 30

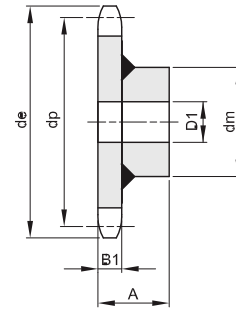
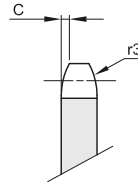

B1	C	r3
8,8	3	50

Material Fe(Hierro)

Z	de	dp	dm	D1	A	Kg.
8	149,0	132,74	58	20	39	1,35
10	182,0	164,39	88	20	44	2,85
12	214,0	196,27	88	25	44	3,37
14	247,0	228,29	88	25	44	4,08
16	279,0	260,39	118	30	59	7,34

Z	de	dp	dm	D1	A	Kg.

PASO 75
RODILLO 25

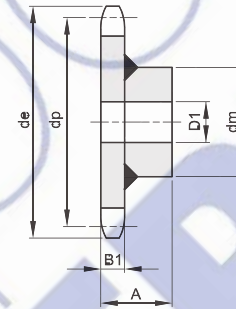
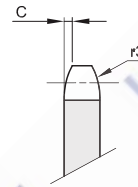

B1	C	r3
10,5	3	50

Material Fe(Hierro)

Z	de	dp	dm	D1	A	Kg.
8	211,0	195,98	88	25	45,5	4,07
10	258,0	242,70	118	25	60,5	7,87

Z	de	dp	dm	D1	A	Kg.

PASO 75
RODILLO 31

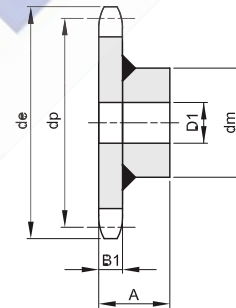
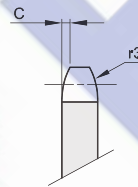

B1	C	r3
13,5	3	50

Material Fe(Hierro)

Z	de	dp	dm	D1	A	Kg.
6	168,0	150,00	88	25	48,5	3,26
8	215,0	195,98	88	25	48,5	4,52
9	238,0	219,30	88	25	48,5	5,36
10	261,0	242,70	118	30	63,5	8,70
11	286,0	266,25	118	30	63,5	9,60
12	309,0	289,80	118	30	63,5	10,73

Z	de	dp	dm	D1	A	Kg.
13	333,0	313,42	118	30	63,5	11,83
14	357,0	337,05	118	30	63,5	13,15
15	380,0	360,73	118	30	63,5	14,45
16	404,0	384,45	133	30	65	17,43
20	499,0	479,40	133	30	65	23,80
21	523,0	503,17	133	30	65	26,07